



**COLOURVUE
ESSENTIALS**
Motorised Roller Blind

WHISPERTECH MOTOR
& REMOTE PROGRAMMING

V271124





Colourvue Essentials

Motorised Roller Blind | Whispertech Motor & Remote Programming

Contents

Whispertech Motor Buttons	3
Whispertech Motor P1 Button Functions	3
Whispertech Remote Buttons	4
Whispertech Remote Functions	4
Whispertech Motor & Remote Programming	
Pair the remote to the motor	5
Check the motor direction	5
Set the top limits	6
Adjust the top limits	6
Set the bottom limits	6
Adjust the bottom limits	7
Delete the limits	7
Setting Fav to a desired height	7
Deleting the height from Fav	8
Add or remove channels from the group	8
View channels in the group	8
Remove remote from the motor	9
Adjusting the speed	9
Touch-to-move mode	9
Troubleshooting	10



Whispertech Motor Buttons

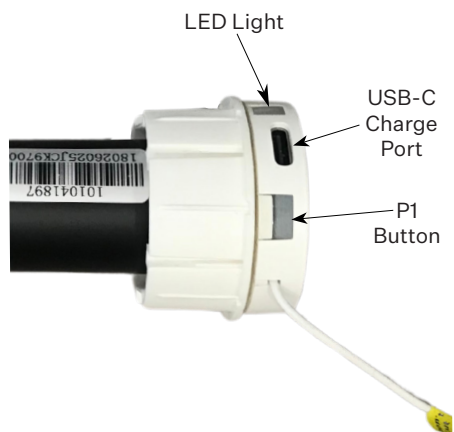

 **Jog = Motor turns down and up in one quick succession.**

Whispertech Motor P1 Button Functions

Pair: Activates motor pairing mode.
Pairing should be complete within 10 seconds.

1. Hold P1 for 2 seconds > Motor will jog x1

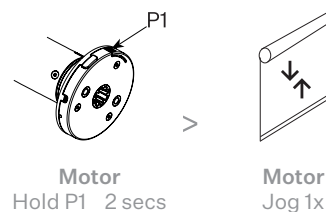

Sleep: Put motor to sleep to deactivate all motor functions.

1. Hold P1 for 6 seconds > Motor will jog x2
2. Hold P1 for 2 seconds to wake up the motor

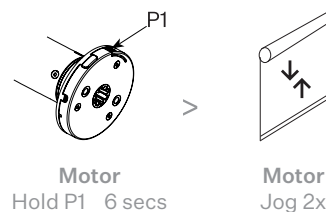

Reverse: Reverse the direction of motor movement after the limits have been set.

1. Hold P1 for 10 seconds > Motor will jog x3

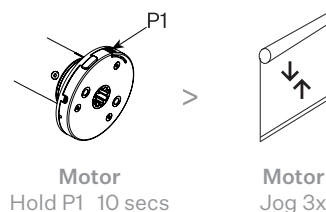

Reset: Resets the motor back to factory mode.
Motor forgets all remotes and limits.

1. Hold P1 for 16 seconds > Motor will jog x4

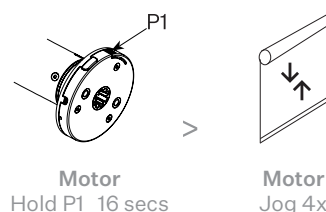

Whispertech Remote Buttons

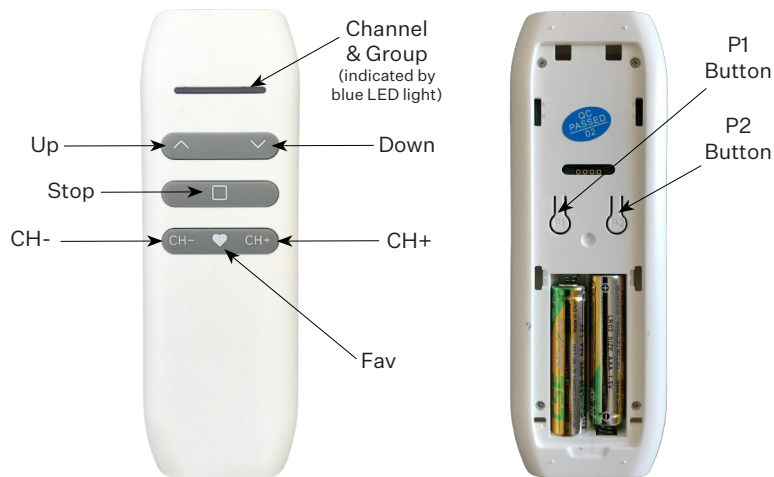

Whispertech Remote Functions

LED light strip: Lights indicate one of six channels or the group.

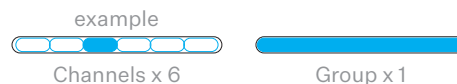

Up & Down: Adjusts the blind height up or down.



Stop: Stops the blind's movement or exit a set-up.



CH- & CH+: Toggle between CH- and CH+ buttons to select a channel or group.



Fav: When set-up, pressing Fav moves the blind to a desired height in between the top and bottom limits.



P1 & P2: Used to program specific remote functions.

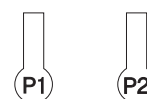

Motor & Remote Programming (from factory reset)

Pair the remote to the motor

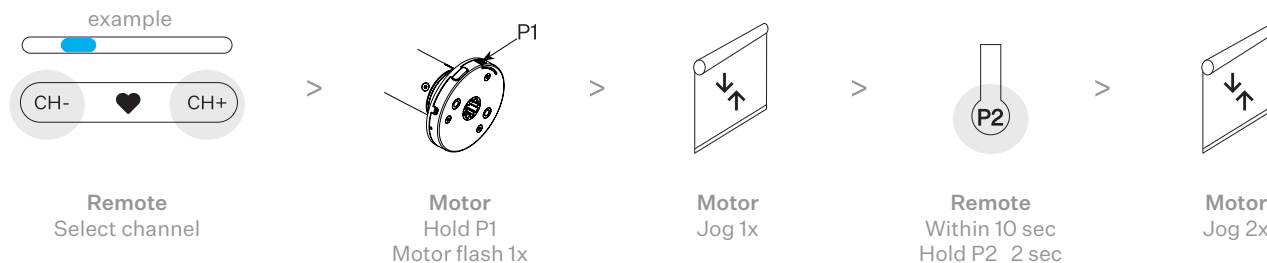

1. Select the desired channel on the remote by toggling between the CH- or CH+ buttons.
2. Hold P1 on the motor head for 2 seconds > Motor will flash 1x and jog 1x
3. Within 10 seconds of step 2, hold P2 on the remote for 2 seconds > Motor will jog 2x
Motor should now be paired to chosen channel.

Check the motor direction

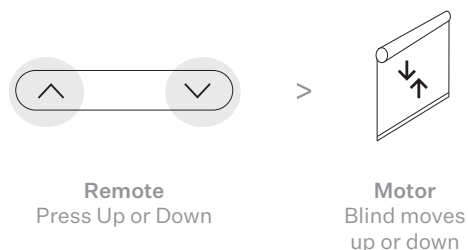

1. Press Up or Down to check the travel direction of the blind. The blind should move in the same direction as the button direction.

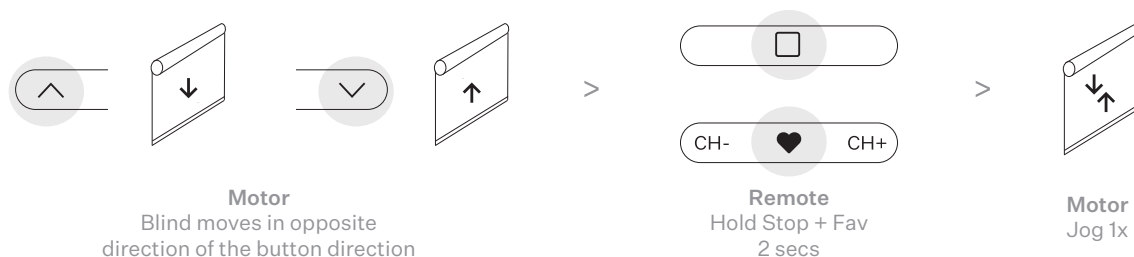

2. If the blind is moving in the opposite direction of the button i.e. press up, blind moves down - hold Fav and Stop for 2 seconds to change the direction of the blind > Motor will jog 1x.
Blind should now move in the same direction of the button direction.

Set the top limits

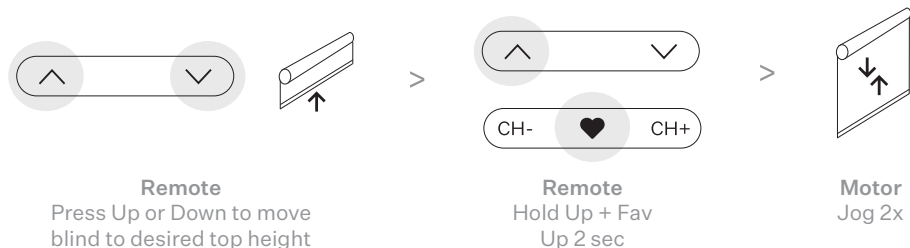

Touch-to-move: This mode moves the blind one jog per button press. It is default programmed before any limits are set. Once limits are set, the touch-to-move mode is disabled.

To by-pass touch-to-move mode while setting the limits, hold the Up or Down button for 2 seconds for continuous operation. Then press Stop to halt the blind at the desired height.

1. Move the blind to the desired top limit by pressing the Up and Down buttons.
2. Hold Up and Fav for 2 seconds > Motor will jog 2x
Top limit should now be set.

Adjust the top limits

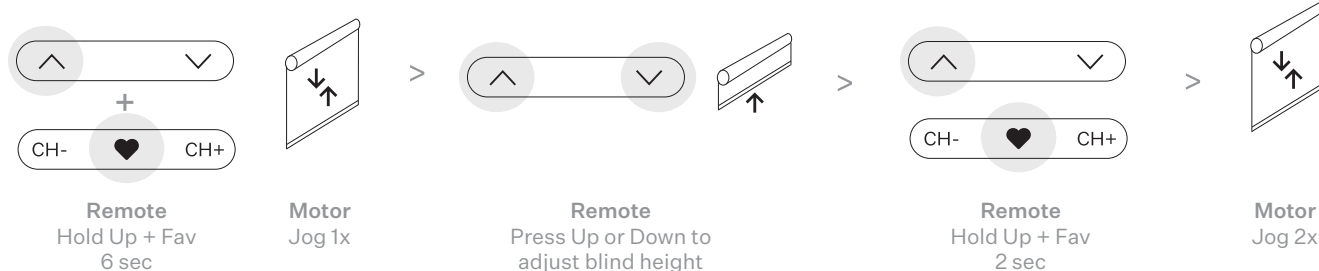

1. Hold Up and Fav for 6 seconds > Motor will jog 1x
2. Move the blind to the desired top limit by pressing the Up and Down buttons
3. Hold Up and Fav for 2 seconds > Motor will jog 2x
Top limit should now be adjusted to the new height.

Set the bottom limits

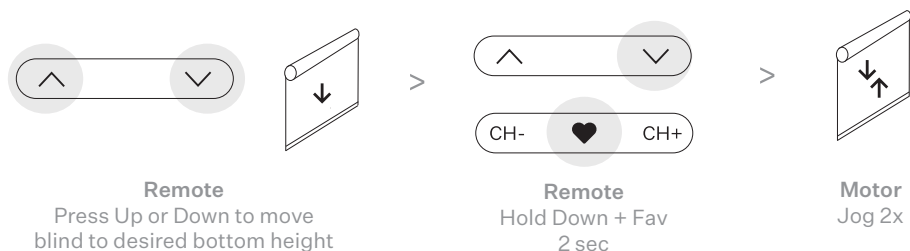

1. Move the blind to the desired bottom limit by pressing the Up and Down buttons
2. Hold Down and Fav for 2 seconds > Motor will jog 2x
Bottom limit should now be set.

Adjust the bottom limits

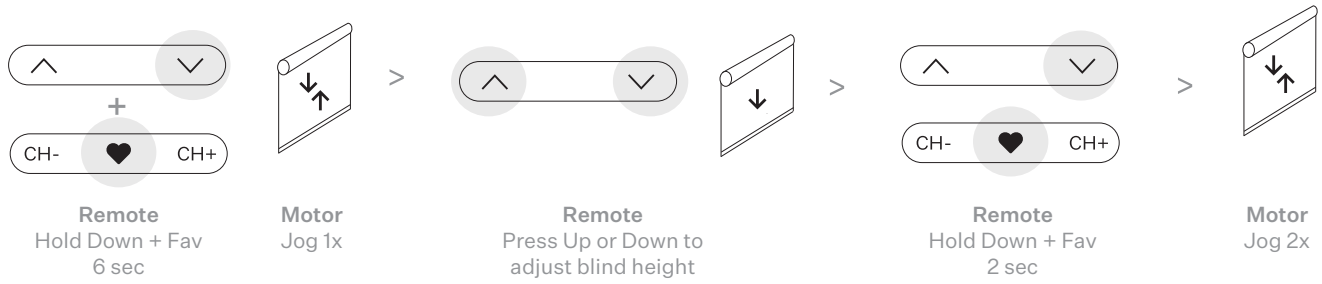

1. Hold Down and Fav for 6 seconds > Motor will jog 1x
2. Move the blind to the desired bottom limit by pressing the Up and Down buttons
3. Hold Down and Fav for 2 seconds > Motor will jog 2x
Bottom limit should now be adjusted to the new height.

Delete the limits

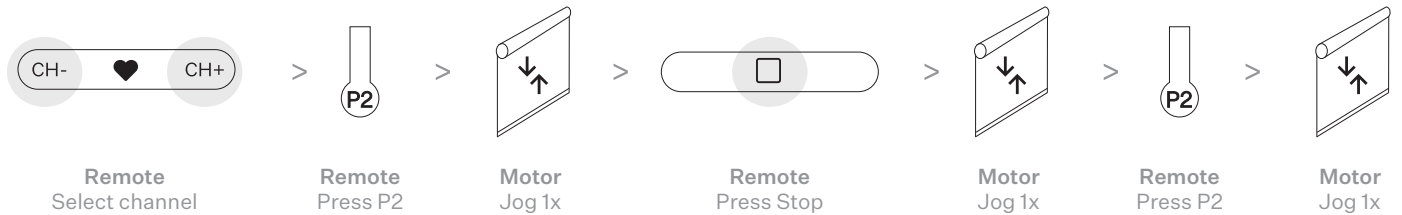

1. Select the channel on the remote by toggling between the CH- or CH+ buttons.
2. Press P2 on the remote > Motor will jog 1x
3. Press Stop > Motor will jog 1x
4. Press P2 on the remote again > Motor will jog 1x
The limits should now be deleted from the motor and remote.

♥ Fav Button: Besides the top and bottom limits, you can have a third height limit, actionable through the Fav button.

Setting Fav to a desired height (After limits are set)

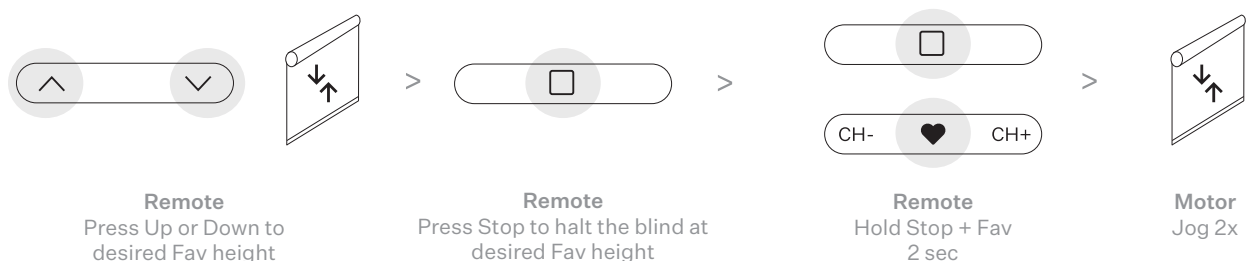

1. Move the blind to the desired Fav height by pressing the Up and Down buttons
2. If the limits are set you will need to press Stop to halt the blind at the desired height.
3. Hold Stop and Fav for 2 seconds > Motor will jog 2x
Fav should now be set to desired height.
To adjust the height, delete the Fav height first, then proceed with the above steps.

Deleting the height limit from Fav

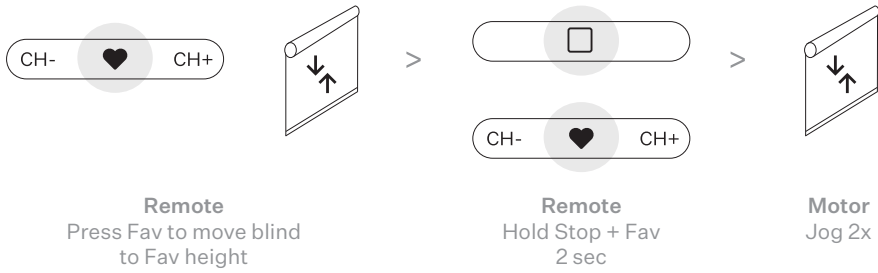

1. Press Fav to move the blind to the existing Fav limit
2. Hold Stop and Fav for 2 seconds > Motor will jog 1x
The set height should now be deleted from the Fav button.

Grouping: There is one group for this remote that allows you to add between 2 and 6 channels.

Add or remove channels from the group

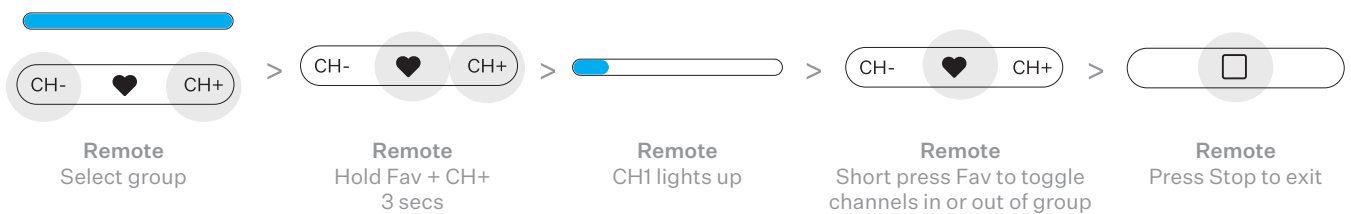

1. Select the group on the remote by toggling between the CH- or CH+ buttons > LED light strip is fully lit.
2. Hold Fav and CH+ for 3 seconds > CH1 lights up
3. Short press Fav to toggle channels into or out of the group
4. Press Stop to exit
Desired channels should now be assigned to the group

View channels in the group

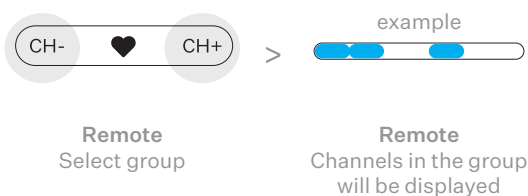

1. Select the group on the remote by toggling between the CH- or CH+ buttons > LED light strip will display the channels assigned to the group

Remote removed: When the remote is removed, the motor will retain any limits set up initially. To operate, you will now need to pair a new remote.

Remove remote from the motor

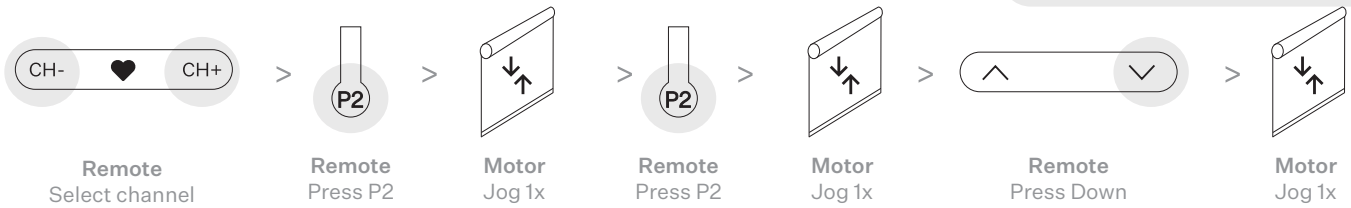

1. Select the channel on the remote by toggling between the CH- or CH+ buttons.
2. Press P2 on the remote > Motor will jog 1x
3. Press P2 again > Motor will jog 1x
4. Press Down > Motor will jog 1x
Motor should now have no remote paired with it.

Speeds: There are 2 speeds. If the motor doesn't jog, the max/min speed has already been set.

Adjusting the speed

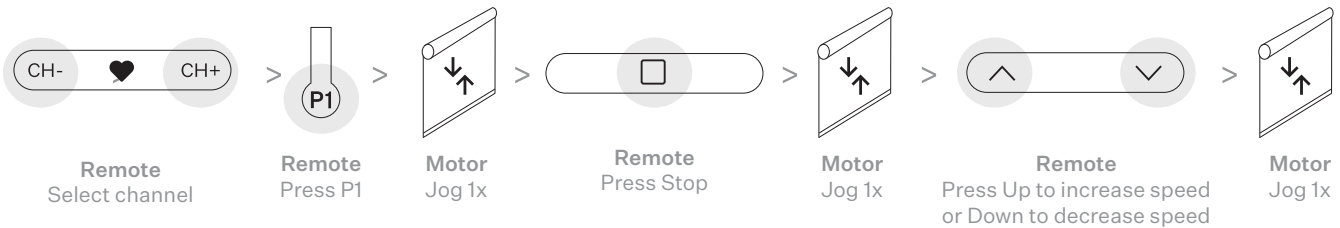

1. Select the channel on the remote by toggling between the CH- or CH+ buttons.
2. Press P1 on the remote > Motor will jog 1x
3. Press Stop on the remote > Motor will jog 1x
4. To increase speed, press Up, or to decrease speed, press Down > Motor will jog 1x
The speed should now be adjusted.

Touch-to-move: This mode moves the blind one jog per button press. It is default programmed before any limits are set. Once limits are set the mode is disabled.

Enable touch-to-move mode (After limits have been set)



1. Select the channel on the remote by toggling between the CH- or CH+ buttons.
2. Press P2 on the remote > Motor will jog 1x
3. Press Stop > Motor will jog 1x
4. Press Stop again > Motor will jog 1x
The motor will now jog once per Up or Down press.
To exit touch-to-move mode, perform steps 1 to 4 again.

Troubleshooting

Fault	Cause	Solution
Motor does not work	Remote not paired	Add remote
	Motor in sleep mode	Wake motor by holding the P1 button on the motor for 2 seconds
	Low battery	Charge motor with USB-C cable
Motor stops suddenly	Upper and lower limit set incorrectly	Adjust limits
	Blind exceeded rated load	Adjust load
	Low battery	Charge motor with USB-C cable
LED on motor flashes 8x when motor moves	Low battery	Charge motor with USB-C cable

For any programming fails, and only after the above solutions have been exhausted, perform a factory reset on the motor and start the motor/remote pair set-up again.